

**88, KENTUCKY, AVENUE, WILMINGTON, OH, 45177**

<https://www.flourishteam.com>

88, Kentucky,  
Avenue,  
Wilmington, OH,  
45177



**\$272,900**

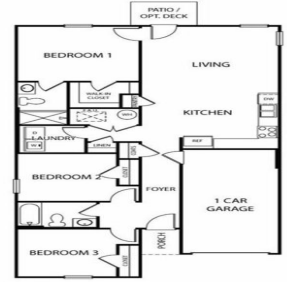

Charming new Sullivan plan by D.R. Horton in beautiful Creekview featuring an open concept design with an wonderful kitchen with appliances and pantry that is open to great room. Primary bedroom with an en suite that includes a walk-in shower and walk-in closet. There are 2 additional bedrooms and a centrally located hall bathroom. 1 [...]

- 3 beds
- 2.00 baths
- Single Family
- Residential
- Active
- 1183 sq ft

## Rooms & Units Description

**Rooms Total: 5**

**Room Count: 5**

**Number Of Full Baths On Level 1: 2, 0**



---

## Location Details

**County Or Parish:** Clinton

**School District:**  
Wilmington

**Directions:** I-71 to 73-E Take US-68 ramp to Xenia/Wilmington Right US-68 S, Slight Left Lorish Ave, Left 2nd cross street to N Lincoln St, Right E Kentucky Ave.

**Zoning:** Residential

---

## Property Details

**Lot Dimensions:** Not Available

**Parcel Number:** 290161607004200

**Construction Type:** Stone,Vinyl

**New Construction:** New

**Levels:** 1 Story

**Subdivision Name:** Creekview

**Distressed Property:** None

**Transaction Type:** Sale

---

## Property Features

**Outside Features:** Porch, Porch

**Inside Features:** Smoke Alarm(s),Walk in Closet

**Utilities:** City Water,Natural Gas

**Appliances:** Dishwasher,Garbage Disposal,Home Warranty,Microwave,Range

**Basement:** Slab

**Windows:** Insulated,Vinyl

**Heating:** Forced Air,Natural Gas

**Cooling:** Central

**Kitchen Features:** Laminate Counters,Open to Family Room,Pantry

**Garage:** 1 Car,Attached,Opener

---

## Miscellaneous

**HOA Condo Fee:** 600.00

**HOA Fee Frequency:** Annually

**Assessments:** Of Record



---

## Courtesy of

**Office Name:** H.M.S. Real Estate

**Agent Name:** Alexander A Hencheck Jr

**Agent Email:** [mlsinfo@hmsmarketingservices.com](mailto:mlsinfo@hmsmarketingservices.com) **Agent Phone:** (513) 469-2424

